

CDB70/35

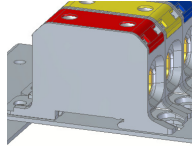

CDB70/35 : 70 sq.mm Distribution Terminal Block with 2 Incoming wire 70 sq.mm and 1 Outgoing wire 35 sq.mm

CDB series distribution terminal blocks are preferred for application using wires of large cross section. These terminal block can be easily mounted on Din Rails and with the help of screws can also be mounted on the surface of mounting plate. CDB70/35 Terminal Blocks are designed in conformance to IEC 60947-7-1 and are suitable for use with aluminium and copper wires. These terminal block offers IP-20 shock proof protection.

TECHNICAL DATA

| | |
|------------------------|-----------------------|
| Rated Voltage | 1000 V |
| Rated Current | 200 A |
| Tightening Torque | 22 Nm |
| Housing Material | Polymide |
| Standard Colour | Grey |
| Product Function | Feed Through |
| Wire Entry Orientation | Side Entry |
| Mounting Possibility | DIN 35/DIN 35-15 Rail |
| Screw Size | M14 |
| Operated by | Allen Key |
| Rated Surge Voltage | 8 KV |
| Pollution Degree | 3 |

CONNECTION DATA

| | |
|--|--------------------|
| Conductor Cross Section Stranded max. - Input Side | 70 mm ² |
| Conductor Cross Section Stranded max.- Output Side | 35 mm ² |

DIMENSIONS

| | |
|-------------------|---------|
| Height | 49.5 mm |
| Length | 88 mm |
| Width (Thickness) | 24 mm |

ORDERING INFORMATION

| CAT. NO. | DESCRIPTION | STD. PACK |
|----------|--------------------------------------|-----------|
| CDB70/35 | 70 sq.mm Distribution Terminal Block | 10 |

NOTES

The Rated current is with the use of copper (Cu) conductor/Wire