

STH3

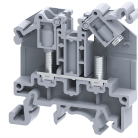

connectwell
THE RIGHT CONNECTION

6 sq. mm Stud Type Terminal Block - with captive nuts.

These Terminal Blocks are preferred for applications where the connections are subjected to severe vibrations. The wire is crimped to ring /fork type Lug (Ferrule) and is screwed on to flat current bar on the Terminal Block. The fastening nut always remains captive in the hinged plastic carrier. The Hinged Carrier should be lifted to insert the lugs and then snapped back into position. The nut can then be fastened to complete the connection. By the virtue of the hinged design the Terminal Blocks apart from shrouding the live parts, providing IP20 protection, saves considerable time in wiring.

TECHNICAL DATA

Rated Voltage	1000 V
Rated Current	41 A
Tightening Torque	0.5 Nm
Housing Material	Polymide
Product Function	Feed Through
Wire Entry Orientation	Side entry
Mounting Possibility	DIN 32/DIN 35/DIN 35-15 Rail
Stud Size	M3
Rated Surge Voltage	8 KV
Pollution Degree	3

CONNECTION DATA

Conductor Cross Section Stranded min.	1.5 mm ²
Conductor Cross Section Stranded max.	6 mm ²
Conductor Cross Section AWG/Kcmil min	22 AWG
Conductor Cross Section AWG/Kcmil max	8 AWG
Conductor Cross Section Solid min	1.5 mm ²
Conductor Cross Section Solid max	6 mm ²
2 Conductors with same Cross Section Stranded with TWIN Ferrule/Lug min	1.5 mm ²
2 Conductor with same Cross Section Stranded with TWIN Ferrule/Lug max	6 mm ²

DIMENSIONS

Height with DIN 32 rail	52.1 mm
Height with DIN 35 x 15 mm rail	54.75 mm
Height with DIN 35 x 7.5 mm rail	47.25 mm
Length	47 mm
Width (Thickness)	9 mm

ORDERING INFORMATION

CAT. NO.	DESCRIPTION	STD. PACK
STH3	6 Sq.mm M4 captive nut Type Terminal Block in Grey Colour	50
STH3BK	6 Sq.mm M4 captive nut Type Terminal Block in Black Colour	50
STH3BU	6 Sq.mm M4 captive nut Type Terminal Block in Blue Colour	50
STH3GN	6 Sq.mm M4 captive nut Type Terminal Block in Green Colour	50
STH3R	6 Sq.mm M4 captive nut Type Terminal Block in Red Colour	50

ORDERING INFORMATION

CAT. NO.	DESCRIPTION	STD. PACK
STH3Y	6 Sq.mm M4 captive nut Type Terminal Block in Yellow Colour	50

ACCESSORIES

IMAGES	CAT. NO.	DESCRIPTION	STD. PACK
	CA501-1M	Din 32 Rail unslotted 1 meter	50
	CA501-1M-S	Din 32 Rail slotted 1 meter	50
	CA501-2M	Din 32 Rail unslotted 2 meter	50
	CA501-2M-S	Din 32 Rail slotted 2 meter	50
	CA701-1M	Din 35 Rail unslotted 1 meter	50
	CA701-2M	Din 35 Rail unslotted 2 meter	50
	CA701-2M-S	Din 35 Rail slotted 2 meter	50
	CA701-1M-S	Din 35 Rail slotted 1 meter	50
	CA701-15-1M	Din 35 Rail 15 deep unslotted 1 meter	50
	CA701-15-1M-S	Din 35 Rail 15 deep slotted 1 meter	50
	CA701-15-2M	Din 35 Rail 15 deep unslotted 2 meter	50
	CA701-15-2M-S	Din 35 Rail 15 deep slotted 2 meter	50
	CA702	End Clamp in Polyamide 66 suitable for Din 32 / Din 35 / Din 35-15 Rails	50
	CA802	End Clamp in Polyamide suitable for Din 35 / Din 35-15 Rails	50
	EPSTH3	End Plate in Grey colour suitable for STH3 Terminal Block	50
	CA514/15-2	Insulated Fork Type Shorting link 2 Pole	100
	CA514/15-3	Insulated Fork Type Shorting link 3 Pole	100
	CA514/15-4	Insulated Fork Type Shorting link 4 Pole	100
	CA514/17-2	Insulated Ring Type Shorting link 2 Pole	100
	CA514/17-3	Insulated Ring Type Shorting link 3 Pole	100
	CA514/17-4	Insulated Ring Type Shorting link 4 Pole	100

STH3

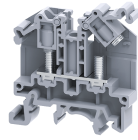

connectwell
THE RIGHT CONNECTION

ACCESSORIES

IMAGES	CAT. NO.	DESCRIPTION	STD. PACK
	CA512/15-2	Uninsulated Fork Type Shorting link 2 Pole	100
	CA512/15-3	Uninsulated Fork Type Shorting link 3 Pole	100
	CA512/15-4	Uninsulated Fork Type Shorting link 4 Pole	100
	CA512/17-2	Removable Shorting Link available in 2 Pole	100
	CA512/17-3	Removable Shorting Link available in 3 Pole	100
	CA512/17-4	Removable Shorting Link available in 4 Pole	100
	CA773/2	Pre Assembled Shorting Link Assemblies with 2 poles	100
	CA773/3	Pre Assembled Shorting Link Assemblies with 3 poles	50
	CA773/4	Pre Assembled Shorting Link Assemblies with 4 poles	50
	CA773/10	Pre Assembled Shorting Link Assemblies with 10 poles	10
	CA509/K8	Marking Tag with Vertical printing.	100
	SCS0.8/4	Electricians Screwdriver for slotted screws	10
	MC8	MARKER CARD 8MM PITCH WITH 48 TAGS	10

APPROVALS



NOTES

The Rated current is with the use of copper (Cu) conductor/Wire

RATINGS AS PER STANDARDS

STANDARDS	UL 1059	IEC/EN60947-7-1	CSA C.22.2 No:158
Approvals	UL	CE	CSA
Conductor Cross Section Stranded min.	22 AWG	1.5 mm ²	22 AWG
Conductor Cross Section Stranded max.	8 AWG	6 mm ²	8 AWG
Rated Voltage	600 V	1000 V	600 V
Rated Current	50 A	41 A	50 A
Tightening Torque	4.5 lb-in	0.5 Nm	4.5 lb-in