

CSC16T

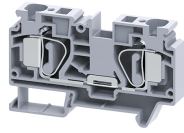

connectwell
THE RIGHT CONNECTION

16 sq.mm Spring Clamp Feed Through Terminal Blocks

The Spring Clamp is operated by using a screw driver to provide an access to the wire through an opening in the spring clamp. The inserted wire gets clamped on to the current bar when the screw driver is removed.

TECHNICAL DATA

Rated Voltage	800 V
Rated Current	76 A
Housing Material	Polymide
Standard Colour	Grey
Product Function	Feed Through
Wire Entry Orientation	Top Entry
Mounting Possibility	DIN 35/DIN 35-15 Rail
Operated by	Screw Driver
Rated Surge Voltage	8 KV
Pollution Degree	3

CONNECTION DATA

Conductor Cross Section Stranded min.	1.5 mm ²
Conductor Cross Section Stranded max.	16 mm ²
Conductor Cross Section AWG/Kcmil min	16 AWG
Conductor Cross Section AWG/Kcmil max	4 AWG
Conductor Cross Section Stranded with Ferrule/Lug min	1.5 mm ²
Conductor Cross Section Stranded with Ferrule/Lug max	16 mm ²
2 Conductors with same Cross Section Stranded min	1.5 mm ²
2 Conductor with same Cross Section Stranded max	4.0 mm ²
Stripping Length	20 mm

DIMENSIONS

Height with DIN 35 x 15 mm rail	58.7 mm
Height with DIN 35 x 7.5 mm rail	51.2 mm
Length	82 mm
Width (Thickness)	12 mm

ORDERING INFORMATION

CAT. NO.	DESCRIPTION	STD. PACK
CSC16T	16 sq.mm Feed Through Spring Clamp Terminal Block in Grey colour	50
CSC16TR	16 sq.mm Feed Through Spring Clamp Terminal Block in Red colour	50
CSC16TBK	16 sq.mm Feed Through Spring Clamp Terminal Block in Black colour	50
CSC16TBU	16 sq.mm Feed Through Spring Clamp Terminal Block in Blue colour	50
CSC16TY	16 sq.mm Feed Through Spring Clamp Terminal Block in Yellow colour	50

ORDERING INFORMATION

CAT. NO.	DESCRIPTION	STD. PACK
CSC16TGN	16 sq.mm Feed Through Spring Clamp Terminal Block in Green colour	50

ACCESSORIES

IMAGES	CAT. NO.	DESCRIPTION	STD. PACK
	CA701-1M	Din 35 Rail unslotted 1 meter	50
	CA701-2M	Din 35 Rail unslotted 2 meter	50
	CA701-2M-S	Din 35 Rail slotted 2 meter	50
	CA701-1M-S	Din 35 Rail slotted 1 meter	50
	CA701-15-1M	Din 35 Rail 15 deep unslotted 1 meter	50
	CA701-15-1M-S	Din 35 Rail 15 deep slotted 1 meter	50
	CA701-15-2M	Din 35 Rail 15 deep unslotted 2 meter	50
	CA701-15-2M-S	Din 35 Rail 15 deep slotted 2 meter	50
	CA103	EndClamp in Polyamide suitable for Din 35/Din 35-15 rails	50
	CA702	End Clamp in Polyamide 66 suitable for Din 32 / Din 35 / Din 35-15 Rails	50
	CA802	End Clamp in Polyamide suitable for Din 35 / Din 35-15 Rails	50
	EPCSC16T	End Plate in Grey.	50
	EPCSC16TBU	End Plate in Blue colour	50
	CA801/5	Insulated Push-In Type shorting link	100
	CA509/K12	Marking Tag Blank suitable for CTS16U / CTS25UN / CGT16N / CDB25 / CMDB25 / CSC16T / CSCG16T / CY16 / CYG16 Terminal Blocks	100
	SWL16	Warning label suitable for 12mm wide terminal block	50
	SCS1/5.5	Electricians Screwdriver for slotted screws	10
	JXS16/2.5	Step Down Shorting Link for CSC16T to CX2.5 and CP2.5 series Terminals	10

CSC16T

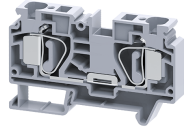

connectwell
THE RIGHT CONNECTION

ACCESSORIES

IMAGES	CAT. NO.	DESCRIPTION	STD. PACK
	MC12	MARKER CARD 12MM PITCH WITH 36 TAGS	10

APPROVALS



NOTES

The Rated current is with the use of copper (Cu) conductor/Wire

RATINGS AS PER STANDARDS

STANDARDS	UL 1059	IEC/EN60947-7-1	CSA C.22.2 No:158
Approvals	UL	CE	CSA
Conductor Cross Section Stranded min.	16 AWG	1.5 mm ²	16 AWG
Conductor Cross Section Stranded max.	4 AWG	16 mm ²	4 AWG
Rated Voltage	600 V	800 V	600 V
Rated Current	85 A	76 A	85 A