

CX4

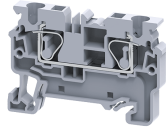

**connectwell**  
THE RIGHT CONNECTION

#### 4 sq.mm Spring Clamp Feed Through compact Terminal Blocks

The Spring Clamp is operated by using a screw driver to provide an access to the wire through an opening in the spring clamp. The inserted wire gets clamped on to the current bar when the screw driver is removed.

#### TECHNICAL DATA

Rated Voltage	1000 V
Rated Current	32 A
Housing Material	Polymide
Product Function	Feed Through
Wire Entry Orientation	Top
Mounting Possibility	DIN 35/DIN 35-15 Rail
Operated by	Screw Driver
Rated Surge Voltage	8 KV
Pollution Degree	3

#### CONNECTION DATA

Conductor Cross Section Stranded min.	0.2 mm <sup>2</sup>
Conductor Cross Section Stranded max.	4 mm <sup>2</sup>
Conductor Cross Section AWG/Kcmil min	24 AWG
Conductor Cross Section AWG/Kcmil max	10 AWG
Conductor Cross Section Stranded with Ferrule/Lug min	0.2 mm <sup>2</sup>
Conductor Cross Section Stranded with Ferrule/Lug max	4 mm <sup>2</sup>
Conductor Cross Section Solid min	0.2 mm <sup>2</sup>
Conductor Cross Section Solid max	6 mm <sup>2</sup>
2 Conductors with same Cross Section Stranded with TWIN Ferrule/Lug min	0.2 mm <sup>2</sup>
2 Conductor with same Cross Section Stranded with TWIN Ferrule/Lug max	1.5 mm <sup>2</sup>
Stripping Length	10 mm

#### DIMENSIONS

Height with DIN 35 x 15 mm rail	45.5 mm
Height with DIN 35 x 7.5 mm rail	38 mm
Length	54.8 mm
Width (Thickness)	6 mm

#### ORDERING INFORMATION

CAT. NO.	DESCRIPTION	STD. PACK
CX4	4 sq.mm Feed Through Spring Clamp Terminal Block in Grey colour	100
CX4BU	4 sq.mm Feed Through Spring Clamp Terminal Block in Blue colour	100
CX4BK	4 sq.mm Feed Through Spring Clamp Terminal Block in Black colour	100
CX4O	4 sq.mm Feed Through Spring Clamp Terminal Block in Orange colour	100

#### ORDERING INFORMATION

CAT. NO.	DESCRIPTION	STD. PACK
CX4R	4 sq.mm Feed Through Spring Clamp Terminal Block in Red colour	100
CX4Y	4 sq.mm Feed Through Spring Clamp Terminal Block in Yellow colour	100
CX4W	4 sq.mm Feed Through Spring Clamp Terminal Block in White colour	100
CX4GN	4 sq.mm Feed Through Spring Clamp Terminal Block in Green colour	100

#### ACCESSORIES

IMAGES	CAT. NO.	DESCRIPTION	STD. PACK
	CA701-1M	Din 35 Rail unslotted 1 meter	50
	CA701-2M	Din 35 Rail unslotted 2 meter	50
	CA701-2M-S	Din 35 Rail slotted 2 meter	50
	CA701-1M-S	Din 35 Rail slotted 1 meter	50
	CA701-15-1M	Din 35 Rail 15 deep unslotted 1 meter	50
	CA701-15-1M-S	Din 35 Rail 15 deep slotted 1 meter	50
	CA701-15-2M	Din 35 Rail 15 deep unslotted 2 meter	50
	CA701-15-2M-S	Din 35 Rail 15 deep slotted 2 meter	50
	CA103	EndClamp in Polyamide suitable for Din 35/DIN 35-15 rails	50
	CA702	End Clamp in Polyamide 66 suitable for Din 32 / Din 35 / Din 35-15 Rails	50
	CA802	End Clamp in Polyamide suitable for Din 35 / Din 35-15 Rails	50
	EPCX4	End Plate in Grey colour	50
	EPCX4BU	End Plate in Blue colour	50
	PPCX4	Partition Plate in Grey colour	50
	JX4/2	Shorting Link for 6 mm wide TB	100
	JX4/3	Shorting Link for 6 mm wide TB	50
	JX4/4	Shorting Link for 6 mm wide TB	50
	JX4/5	Shorting Link for 6 mm wide TB	50
	JX4/8	Shorting Link for 6 mm wide TB	10
	JX4/10	Shorting Link for 6 mm wide TB	10
JX4/16	Shorting Link for 6 mm wide TB	10	

CX4

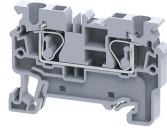

**connectwell**  
THE RIGHT CONNECTION

**ACCESSORIES**

IMAGES	CAT. NO.	DESCRIPTION	STD. PACK
	CA509/K6	Blank Marking Tag	100
	SCS0.5/3	Electricians Screwdriver for slotted screws	10
	JXS6/4	Step Down Shorting Link for CX series	10
	JXS10/4	Step Down Shorting Link for CX series	10
	TX2.5	TEST PLUG	20
	MC6	MARKER CARD 6MM PITCH WITH 72 TAGS	10

**APPROVALS**



**NOTES**

The Rated current is with the use of copper (Cu) conductor/Wire

**RATINGS AS PER STANDARDS**

STANDARDS	UL 1059	CSA C.22.2 No:158	IEC/EN60947-7-1
Approvals	UL	CSA	CE
Conductor Cross Section Stranded min.	24 AWG	24 AWG	0.2 mm <sup>2</sup>
Conductor Cross Section Stranded max.	10 AWG	10 AWG	4 mm <sup>2</sup>
Rated Voltage	600 V	600 V	1000 V
Rated Current	30 A	30 A	32 A