

CXM2.5

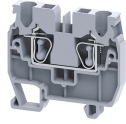

2.5 sq. mm Micro spring clamp Terminal Blocks.

A perfect solution for extremely compact wiring applications, these terminal block are modular and can be stacked to form multi-pole terminal block assemblies.

TECHNICAL DATA

Rated Voltage	1000 V
Rated Current	24 A
Housing Material	Polymide
Product Function	Feed Through
Wire Entry Orientation	Top
Mounting Possibility	DIN 15 Rail
Rated Surge Voltage	8 KV
Pollution Degree	3

CONNECTION DATA

Conductor Cross Section Stranded min.	0.2 mm ²
Conductor Cross Section Stranded max.	2.5 mm ²
Conductor Cross Section AWG/Kcmil min	24 AWG
Conductor Cross Section AWG/Kcmil max	12 AWG
Conductor Cross Section Stranded with Ferrule/Lug min	0.2 mm ²
Conductor Cross Section Stranded with Ferrule/Lug max	2.5 mm ²
2 Conductors with same Cross Section Stranded min	0.2 mm ²
2 Conductor with same Cross Section Stranded max	1.5 mm ²
Conductor Cross Section Solid min	0.2 mm ²
Conductor Cross Section Solid max	4 mm ²
Stripping Length	10 mm

DIMENSIONS

Height with DIN 15 x 5 mm rail	35 mm
Length	37 mm
Width (Thickness)	5 mm

ORDERING INFORMATION

CAT. NO.	DESCRIPTION	STD. PACK
CXM2.5	2.5 sqmm Micro Spring Clamp Terminal Block in Grey colour.	100
CXM2.5R	2.5 sqmm Micro Spring Clamp Terminal Block in Red colour.	100
CXM2.5Y	2.5 sqmm Micro Spring Clamp Terminal Block in Yellow colour.	100
CXM2.5BU	2.5 sqmm Micro Spring Clamp Terminal Block in Blue colour.	100
CXM2.5BK	2.5 sqmm Micro Spring Clamp Terminal Block in Black colour.	100

ORDERING INFORMATION

CAT. NO.	DESCRIPTION	STD. PACK
CXM2.5GN	2.5 sqmm Micro Spring Clamp Terminal Block in Green colour.	100

ACCESSORIES

IMAGES	CAT. NO.	DESCRIPTION	STD. PACK
	CA601	Din 15 Rail unslotted	100
	CA601-1M	DIN 15 RAIL 1 METER SLOTTED	50
	SCS0.5/3	Electricians Screwdriver for slotted screws	10
	EPCXM2.5	End Plate in Grey Colour	50

	JX2.5/2	Shorting Link for 2.5 sq mm series	100
	JX2.5/3	Shorting Link for 2.5 sq mm series	50
	JX2.5/4	Shorting Link for 2.5 sq mm series	50
	JX2.5/5	Shorting Link for 2.5 sq mm series	50
	JX2.5/6	Shorting Link for 2.5 sq mm series	50
	JX2.5/7	Shorting Link for 2.5 sq mm series	10
	JX2.5/8	Shorting Link for 2.5 sq mm series	10
	JX2.5/10	Shorting Link for 2.5 sq mm series	10
JX2.5/20	Shorting Link for 2.5 sq.mm series	10	

	MS5	Marking Tag Blank suitable for CXM2.5 / CXMG2.5 Terminal Blocks	100
--	-----	---	-----

APPROVALS



NOTES

The Rated current is with the use of copper (Cu) conductor/Wire

CXM2.5

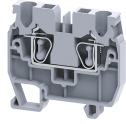

connectwell
THE RIGHT CONNECTION

RATINGS AS PER STANDARDS

STANDARDS	UL 1059	CSA C.22.2 No:158	IEC/EN60947-7-1
Approvals	UL	CSA	CE
Conductor Cross Section Stranded min.	24 AWG	24 AWG	0.2 mm ²
Conductor Cross Section Stranded max.	12 AWG	12 AWG	2.5 mm ²
Rated Voltage	600 V	600 V	1000 V
Rated Current	20 A	20 A	24 A