

CXS6

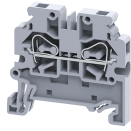

**connectwell**  
THE RIGHT CONNECTION

### 6 sq.mm Spring Clamp Feed Through Side Entry Terminal Blocks

The Spring Clamp is operated by using a screw driver to provide an access to the wire through an opening in the spring clamp. The inserted wire gets clamped on to the current bar when the screw driver is removed.

#### TECHNICAL DATA

Rated Voltage	1000 V
Rated Current	41 A
Housing Material	Polymide
Standard Colour	Grey
Product Function	Feed Through
Wire Entry Orientation	Side
Mounting Possibility	DIN 35/DIN 35-15 Rail
Operated by	Screw Driver
Rated Surge Voltage	8 KV
Pollution Degree	3

#### CONNECTION DATA

Conductor Cross Section Stranded min.	0.2 mm <sup>2</sup>
Conductor Cross Section Stranded max.	6 mm <sup>2</sup>
Conductor Cross Section AWG/Kcmil min	24 AWG
Conductor Cross Section AWG/Kcmil max	8 AWG
Conductor Cross Section Stranded with Ferrule/Lug min	0.2 mm <sup>2</sup>
Conductor Cross Section Stranded with Ferrule/Lug max	6 mm <sup>2</sup>
2 Conductors with same Cross Section Stranded with TWIN Ferrule/Lug min	0.2 mm <sup>2</sup>
2 Conductor with same Cross Section Stranded with TWIN Ferrule/Lug max	6 mm <sup>2</sup>
Stripping Length	13 mm

#### DIMENSIONS

Height	49 mm
Height with DIN 35 x 15 mm rail	57.25 mm
Height with DIN 35 x 7.5 mm rail	49.75 mm
Length	55.4 mm
Width (Thickness)	8 mm

#### ORDERING INFORMATION

CAT. NO.	DESCRIPTION	STD. PACK
CXS6	6 sq.mm Feed Through Spring Clamp Side Entry Terminal Block in Grey colour	50
CXS6BU	6 sq.mm Feed Through Spring Clamp Side Entry Terminal Block in Blue colour	50

CXS6

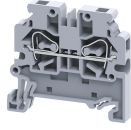

**connectwell**  
THE RIGHT CONNECTION

**APPROVALS**



**NOTES**

All the values mentioned are tentative and might change. The Rated current is with the use of copper (Cu) conductor/Wire

**RATINGS AS PER STANDARDS**

STANDARDS	UL 1059	IEC/EN60947-7-1
Conductor Cross Section Stranded min.	24 AWG	0.2 mm <sup>2</sup>
Conductor Cross Section Stranded max.	8 AWG	6 mm <sup>2</sup>