

CSR2S-
120UYA



connectwell
THE RIGHT CONNECTION

SLIM RELAY MODULE 2CO 120VAC/VDC

- Compact & thin design
- Variety of Operating Voltages.
- High switching current : up to 8A at 24VDC/250VAC
- low coil power consumption.
- LED Indication on Coil activation.
- No requirement on polarity of input voltage
- Possibility of Jumpering Multiple slim relays together

TECHNICAL DATA

Bussing Possibility	Yes, By using shorting link
Supply Voltage Indication	Green LED
Ambient Operating Temperature	-40 to +55 °C
Mounting Possibility	DIN 35/DIN 35-15 Rail
Housing Material	PA 6,6 (V0)
Housing Colour	Grey
Rated Input voltage	120 V
Input Polarity Protection	Rectifier

RELAY GENERAL SPECIFICATIONS

Relay Type	Electromechanical Relay
Relay Make / Manufacturer	Hongfa / HF115F/110-2ZS4BF
Relay Approvals	UL,VDE

RELAY INPUT / COIL SPECIFICATIONS

Nominal Operating Voltage	120VAC V
Nominal Input Current	5.1 mA
Maximum Operating Voltage	132VAC V
Must Operate Voltage	76VAC V
Must Release Voltage	25VAC V
Nominal Input Power	612 mW

RELAY OUTPUT/CONTACT SPECIFICATIONS

Contact Type	2 CO-DPDT
Contact Material	AgNi
Contact Resistance	100 m ohms max
Rated Contact Current (Resistive Load)	8 A
Load Voltage Range	440 VAC, 300 VDC
Maximum Switching Power	2000 VA, 192W

CONNECTION SPECIFICATIONS

Type of Connection	Screw Connection
Wire Stripping Length	10 mm
Torque	0.4 Nm
Torque	4.5 lb-in

CONNECTION SPECIFICATIONS

Min. Wire Size - Stranded(mm2)	0.2 mm ²
Max. Wire Size - Stranded(mm2)	2.5 mm ²
Min. Wire Size - Stranded(AWG)	24 AWG
Max. Wire Size - Stranded(AWG)	12 AWG
Min. Wire Size - Solid	0.2 mm ²
Max. Wire Size - Solid	2.5 mm ²
Min. Wire Size - Solid(AWG)	24 AWG
Max. Wire Size - Solid(AWG)	12 AWG

ORDERING INFORMATION

CAT. NO.	DESCRIPTION	NO. OF CHN.	DIM. DET.	STD. PACK
CSR2S-120UYA	2CO 120 VAC/VDC Slim Relay With Pluggable Relay Rail Mount	1	14 x 94.5 x 101	10

ACCESSORIES

IMAGES	CAT. NO.	DESCRIPTION	STD. PACK
	CA701-1M	Din 35 Rail unslotted 1 meter	50
	CA701-2M	Din 35 Rail unslotted 2 meter	50
	CA701-2M-S	Din 35 Rail slotted 2 meter	50
	CA701-1M-S	Din 35 Rail slotted 1 meter	50
	CA701-15-1M	Din 35 Rail 15 deep unslotted 1 meter	50
	CA701-15-1M-S	Din 35 Rail 15 deep slotted 1 meter	50
	CA701-15-2M	Din 35 Rail 15 deep unslotted 2 meter	50
	CA701-15-2M-S	Din 35 Rail 15 deep slotted 2 meter	50
	SCS0.5/3	Electricians Screwdriver for slotted screws	10
	ECAP 35/15	End Cap in Polyamide suitable for Din 35-15 rails	100
	ECAP 35/7.5	End Cap in Polyamide suitable for Din 35/7.5 rails	100
	CA202	End Clamp in Polyamide suitable for Din 35 / Din 35-15 Rails	25

CSR2S-120UYA



connectwell
THE RIGHT CONNECTION

ACCESSORIES

IMAGES	CAT. NO.	DESCRIPTION	STD. PACK
	IMACC/MR2S/110	2CO 110VDC MODULAR RELAY	100
	JX1.5/14/2	2 WAY SHORTING LNK FOR Slim Relay 2CO Coil Side	50
	JX1.5/14/3	3 WAY SHORTING LNK FOR Slim Relay 2CO Coil Side	50
	JX1.5/14/4	4 WAY SHORTING LNK FOR Slim Relay 2CO Coil Side	50
	JX1.5/7/4	4 WAY SHORTING LNK FOR Slim Relay 2CO Contact Side	50
	JX1.5/7/6	6 WAY SHORTING LNK FOR Slim Relay 2CO Contact Side	50
	JX1.5/7/8	8 WAY SHORTING LNK FOR Slim Relay 2CO Contact Side	50

CIRCUIT DIAGRAM

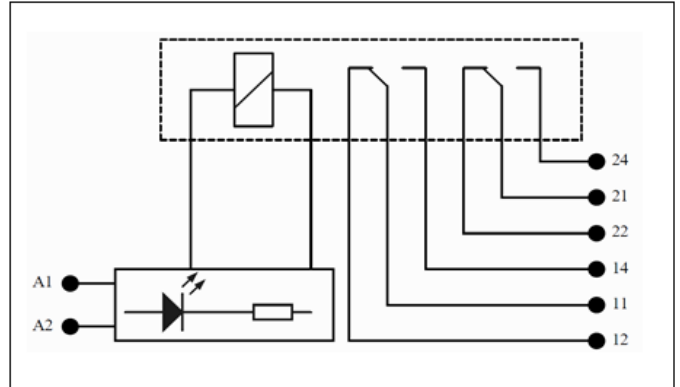

PRODUCT DRAWING

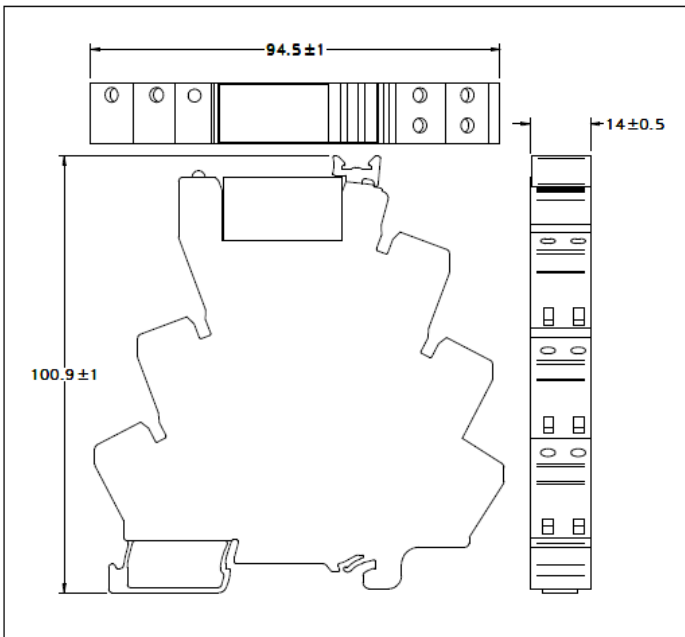

NOTES

Protection Degree:IP20
Pollution Degree:2
Over voltage / Surge voltage category-III
Relay operating time ≤ 15 (msec)
Relay release time ≤ 8(msec)

Dielectric Strength:
1)Between contacts and coil- 5kV AC (50Hz, 1min)
2)Between contact sets- 2.5kV AC(50Hz, 1min)
3)Between open contacts-1kV AC(50Hz, 1min)
4)Between Live parts /DIN rail-2kV AC (50Hz, 1min)

Insulation resistance: 1000M ohm @ 500VDC

Connection wires/ Conductors: 60/75 degC Copper conductor