

CSR1S-230UYB-SN



SLIM RELY MOD EMR 1CO 230VUC-SN SC CL with snubber protection

- Compact 6.0mm thin design
- Integrated protection circuit.
- Variety of Operating Voltages.
- Available in Screw clamp and spring clamp connection.
- High switching current: up to 6A at 250VAC/30VDC
- Low coil power consumption: 175 mW
- LED Indication on Coil activation.
- Possibility of Jumpering by Push in jumpers.
- Easy legibility top marker
- Choice of pluggable Electromechanical Relays Or Solid State Relays.
- Universal approvals like UL, CSA and CE approved Socket and Relay*

TECHNICAL DATA

Bussing Possibility	By Push in Jumpers
Supply Voltage Indication	3mm Green LED
Ambient Operating Temperature	-40 to +55 °C
Mounting Possibility	DIN 35/DIN 35-15 Rail
Housing Material	PA 6,6
Housing Colour	Grey
Rated Voltage	230 V
Input Polarity Protection	RC circuit protection

RELAY GENERAL SPECIFICATIONS

Relay Type	Electromechanical relay
Relay Make / Manufacturer	Connectwell
Dielectric Strength	1000VAC (Between contacts), 4000 VAC (between coil and contacts)
Insulation Resistance	1000MOhm @ 500VDC
Relay Approvals	UL,CE,VDE

RELAY INPUT / COIL SPECIFICATIONS

Nominal Operating Voltage	230 V
Nominal Input Current	3.9 mA
Maximum Operating Voltage	242 V
Must Operate Voltage	170 V
Must Release Voltage	36 V
Nominal Input Power	900 mVA

RELAY OUTPUT/CONTACT SPECIFICATIONS

Contact Type	1 CO
Contact Material	AgNi
Contact Resistance	100 m ohms at 1A 6 VDC
Rated Contact Current (Resistive Load)	6 A
Load Voltage Range	400 VAC, 125 VDC at Reduced Load
Maximum Switching Power	1500 VA, 180W

CONNECTION SPECIFICATIONS

Type of Connection	Screw Connection
Wire Stripping Length	10 mm
Torque	0.4 Nm
Torque	7 lb-in
Min. Wire Size - Stranded(mm2)	0.2 mm ²
Max. Wire Size - Stranded(mm2)	2.5 mm ²
Min. Wire Size - Stranded(AWG)	24 AWG
Max. Wire Size - Stranded(AWG)	12 AWG
Min. Wire Size - Solid	0.2 mm ²
Max. Wire Size - Solid	2.5 mm ²
Min. Wire Size - Solid(AWG)	24 AWG
Max. Wire Size - Solid(AWG)	12 AWG

ORDERING INFORMATION

CAT. NO.	DESCRIPTION	NO. OF CHN.	DIM. DET.	STD. PACK
CSR1S-230UYB-SN	SLIM RELY MOD EMR 1CO 230VUC-SN with snubber protection to protect from short term voltage spikes.	1	6 x 94.5 x 96	10

ACCESSORIES

IMAGES	CAT. NO.	DESCRIPTION	STD. PACK
	CA701-1M	Din 35 Rail unslotted 1 meter	50
	CA701-2M	Din 35 Rail unslotted 2 meter	50
	CA701-2M-S	Din 35 Rail slotted 2 meter	50
	CA701-1M-S	Din 35 Rail slotted 1 meter	50
	CA701-15-1M	Din 35 Rail 15 deep unslotted 1 meter	50
	CA701-15-1M-S	Din 35 Rail 15 deep slotted 1 meter	50
	CA701-15-2M	Din 35 Rail 15 deep unslotted 2 meter	50
	CA701-15-2M-S	Din 35 Rail 15 deep slotted 2 meter	50

CSR1S-
230UYB-SN



connectwell
THE RIGHT CONNECTION

ACCESSORIES

IMAGES	CAT. NO.	DESCRIPTION	STD. PACK
	SCS0.5/3	Electricians Screwdriver for slotted screws	10
	CA509/K6	Blank Marking Tag	100
	JX4/2	Shorting Link for 6 mm wide TB	100
	JX4/3	Shorting Link for 6 mm wide TB	50
	JX4/4	Shorting Link for 6 mm wide TB	50
	JX4/5	Shorting Link for 6 mm wide TB	50
	JX4/8	Shorting Link for 6 mm wide TB	10
	JX4/10	Shorting Link for 6 mm wide TB	10
JX4/16	Shorting Link for 6 mm wide TB	10	
	SRL1-60D	RELAY 1CO 60VDC	10

CIRCUIT DIAGRAM

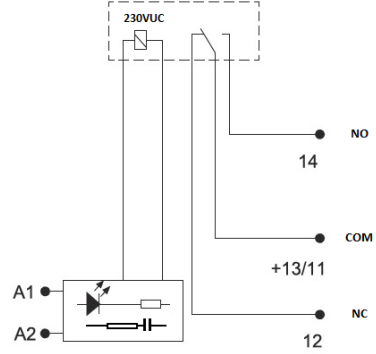

PRODUCT DRAWING

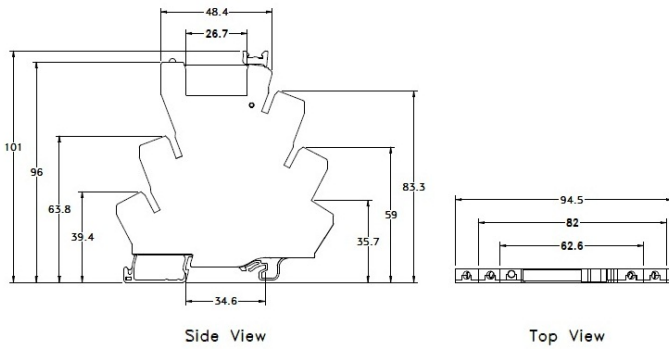

NOTES

Protection Degree:IP20
Pollution Degree:2
Over voltage/Surge voltage category-III
Relay operating time ≤ 8 (msec)
Relay release time ≤ 4 (msec)

Dielectric Strength:
1)Between contacts and coil- 4kV AC (50Hz, 1min)
2)Between contact sets- 2kV AC(50Hz, 1min)
3)Between open contacts-1kV AC(50Hz, 1min)
4)Between Live parts /DIN rail-2kV AC (50Hz, 1min)

Insulation resistance: 1000M ohm@500VDC

Connection wires/ Conductors: 60/75 degC Copper conductor