

# CSER1-24D380A2YC



## Slim SSR Module 24VDC IN 380 VAC OUT 2 Amp

- '-Compact 6.0mm thin design
- '-Variety of Operating Voltages.
- '-Low Drive Current (less than 21 mA)
- '-2500V Dielectric Strength
- '-LED Status Indicator
- '-Photo Isolation
- '-Zero Cross Turn-On (AC Output)
- '-Bipolar Transistor / MOSFET Output (DC Output)
- '-TTL and CMOS compatible
- '-For interface application between PLC and external loads
- '-DIN Rail mounting
- '- Easy to replace pluggable SSR

### TECHNICAL DATA

|                               |                               |
|-------------------------------|-------------------------------|
| Bussing Possibility           | By push in type shorting link |
| Supply Voltage Indication     | 3mm Green LED                 |
| Ambient Operating Temperature | -40to+55 °C                   |
| Mounting Possibility          | DIN 35/DIN 35-15 Rail         |
| Housing Material              | PA6,6                         |
| Housing Colour                | Grey                          |
| Input Polarity Protection     | Rectifier                     |
| Switching device              | Solid State Relay             |

### RELAY GENERAL SPECIFICATIONS

|                 |                    |
|-----------------|--------------------|
| Relay Type      | Solid State Relays |
| Relay Approvals | UL                 |

### RELAY INPUT / COIL SPECIFICATIONS

|                           |          |
|---------------------------|----------|
| Nominal Operating Voltage | 24 VDC   |
| Nominal Input Current     | 12.5 mA  |
| Maximum Operating Voltage | 28.8 VDC |
| Must Operate Voltage      | 9 VDC    |
| Must Release Voltage      | 5.5 VDC  |

### RELAY OUTPUT/CONTACT SPECIFICATIONS

|                                |                   |
|--------------------------------|-------------------|
| Contact Type                   | SPST- NO          |
| Load Current Range             | 0.1 - 2 A         |
| Load Voltage Range             | 48 - 380 VAC      |
| Maximum On State Voltage Drop  | 0.35 VDC          |
| Maximum Transient Voltage      | 600 Vpk           |
| Maximum Leakage Current        | 1.5 mA            |
| Maximum Surge Current          | 80 A              |
| Turn-Off Time                  | 1/2AC Cycle + 1ms |
| Turn-On Time (0 Cross Turn On) | 1/2AC Cycle + 1ms |

### FUSE HOLDER SPECIFICATIONS

|               |        |
|---------------|--------|
| Rated Current | 0.02 A |
|---------------|--------|

### CONNECTION SPECIFICATIONS

|                                |                     |
|--------------------------------|---------------------|
| Type of Connection             | Screw Connection    |
| Wire Stripping Length          | 10 mm               |
| Torque                         | 0.4 Nm              |
| Torque                         | 7 lb-in             |
| Min. Wire Size - Stranded(mm2) | 0.2 mm <sup>2</sup> |
| Max. Wire Size - Stranded(mm2) | 2.5 mm <sup>2</sup> |
| Min. Wire Size - Stranded(AWG) | 24 AWG              |
| Max. Wire Size - Stranded(AWG) | 12 AWG              |
| Min. Wire Size - Solid         | 0.2 mm <sup>2</sup> |
| Max. Wire Size - Solid         | 2.5 mm <sup>2</sup> |
| Min. Wire Size - Solid(AWG)    | 24 AWG              |
| Max. Wire Size - Solid(AWG)    | 12 AWG              |

### ORDERING INFORMATION

| CAT. NO.         | DESCRIPTION   | NO. OF CHN. | DIM. DET.     | STD. PACK |
|------------------|---|-------------|---------------|-----------|
| CSER1-24D380A2YC | Single Channel 24VDC IN 380VAC OUT 2Amp Slim SSR Module with Pluggable Relay Rail Mount | 1           | 6 x 94.5 x 96 | 10        |

### ACCESSORIES

| IMAGES | CAT. NO.   | DESCRIPTION                   | STD. PACK |
|--------|------------|-------------------------------|-----------|
|        | CA701-1M   | Din 35 Rail unslotted 1 meter | 50        |
|        | CA701-2M   | Din 35 Rail unslotted 2 meter | 50        |
|        | CA701-2M-S | Din 35 Rail slotted 2 meter   | 50        |
|        | CA701-1M-S | Din 35 Rail slotted 1 meter   | 50        |

# CSER1-24D380A2YC



## ACCESSORIES

| IMAGES | CAT. NO.      | DESCRIPTION                                 | STD. PACK |
|--------|---------------|---|-----------|
|        | CA701-15-1M   | Din 35 Rail 15 deep unslotted 1 meter       | 50        |
|        | CA701-15-1M-S | Din 35 Rail 15 deep slotted 1 meter         | 50        |
|        | CA701-15-2M   | Din 35 Rail 15 deep unslotted 2 meter       | 50        |
|        | CA701-15-2M-S | Din 35 Rail 15 deep slotted 2 meter         | 50        |
|        | SCS0.5/3      | Electricians Screwdriver for slotted screws | 10        |
|        | CA509/K6      | Blank Marking Tag                           | 100       |
|        | JX4/2         | Shorting Link for 6 mm wide TB              | 100       |
|        | JX4/3         | Shorting Link for 6 mm wide TB              | 50        |
|        | JX4/4         | Shorting Link for 6 mm wide TB              | 50        |
|        | JX4/5         | Shorting Link for 6 mm wide TB              | 50        |
|        | JX4/8         | Shorting Link for 6 mm wide TB              | 10        |
|        | JX4/10        | Shorting Link for 6 mm wide TB              | 10        |
|        | JX4/16        | Shorting Link for 6 mm wide TB              | 10        |

## NOTES

Protection Degree:IP20  
Pollution Degree:2  
Over voltage/Surge voltage category-III  
Relay operating time ≤ 8 (msec)  
Relay release time ≤ 10(msec)

Dielectric Strength:  
1)Between contacts and coil- 4kV AC (50Hz, 1min)  
2)Between contact sets- 2kV AC(50Hz, 1min)  
3)Between open contacts-1kV AC(50Hz, 1min)  
4)Between Live parts /DIN rail-2kV AC (50Hz, 1min)

Insulation resistance: 1000M ohm@500VDC

Connection wires/ Conductors: 60/75 degC Copper conductor

## PRODUCT DRAWING

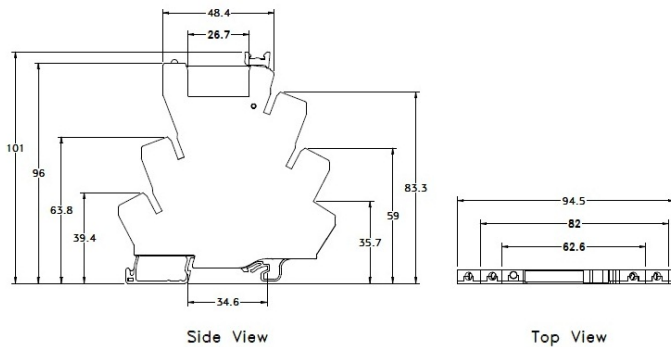

## CIRCUIT DIAGRAM

